

NOTES:

1. THE INSTALLED CABLE BEARER SYSTEM SHALL BE CAPABLE OF WITHSTANDING A POINT LOAD OF 3.5kN APPLIED AT THE END OF THE LONGEST BRACKET ON EACH WALL BEARER.
2. ALL CABLE BEARER COMPONENTS SHALL BE FABRICATED FROM STEEL HOT DIP GALVANISED AFTER FABRICATION IN ACCORDANCE WITH MCDRW CLAUSE 1909.
3. WALL BRACKETS SHALL BE FIXED TO THE WALL OF THE CHAMBER BY RESIN BONDED M12 GALVANISED STEEL STUDS WITH AN AVERAGE TENSILE FAILURE LOAD OF 25kN.
4. ARRANGEMENT SHOWN IS FOR A CHAMBER WHICH HOUSES 2 NO. CJE. WHERE 3 NO. CJE ARE TO BE ACCOMMODATED A THIRD CJE SUPPORT BAR SHALL BE PROVIDED.
5. THE PROPOSED METHOD OF SECURING THE CJE SUPPORT BAR TO THE CABLE BEARER BRACKET SHALL BE SUBMITTED TO THE OVERSEEING ORGANISATION FOR APPROVAL.
6. STANDARD DEPTH ACCOMMODATES UP TO THREE CJE's. IF MORE CJE's ARE REQUIRED THEN A SECOND CHAMBER ADJACENT TO MAY BE RELAXED TO ALLOW TWO SMALL SIZE CJE's TO BE ACCOMMODATED ON THE SAME CJE SUPPORT BAR.
7. CABLES AND CJE's SHALL BE INSTALLED IN ACCORDANCE WITH DRAWINGS RCD/1500/020 AND 021.

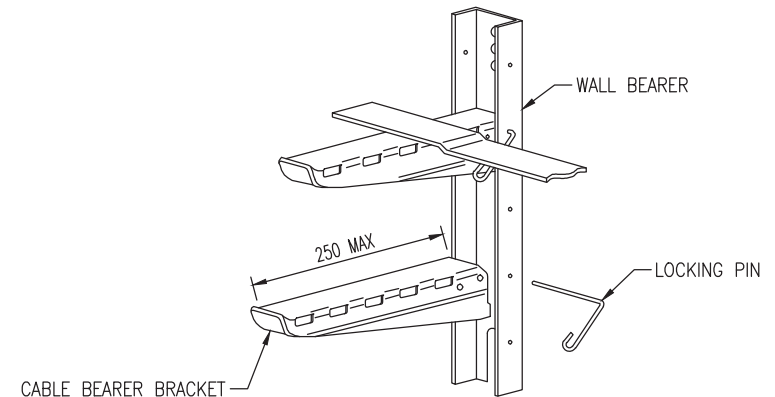
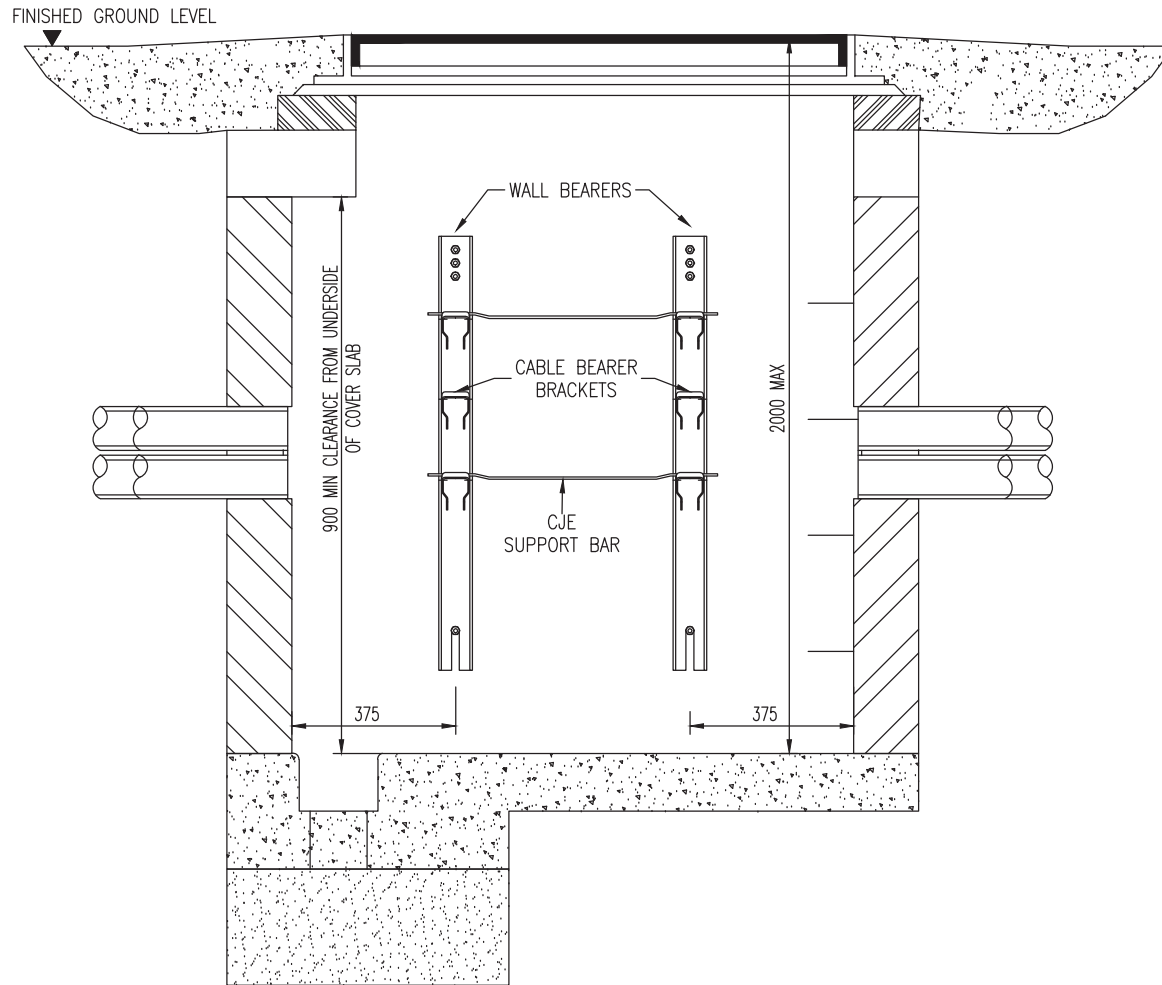

NOT TO SCALE

TII PUBLICATION NUMBER: CC-SCD-01516



ROAD CONSTRUCTION
DETAILS

INSTALLATION
DRAWING TCC

| | |
|-------|-------|
| | |
| P1 | 10/13 |
| Issue | Date |

CHAMBERS CABLE SUPPORT
FOR COMMS I

Drawing No.
RCD/
1500/016