

STRUCTURE CONSTRUCTED AFTER EARTHWORKS

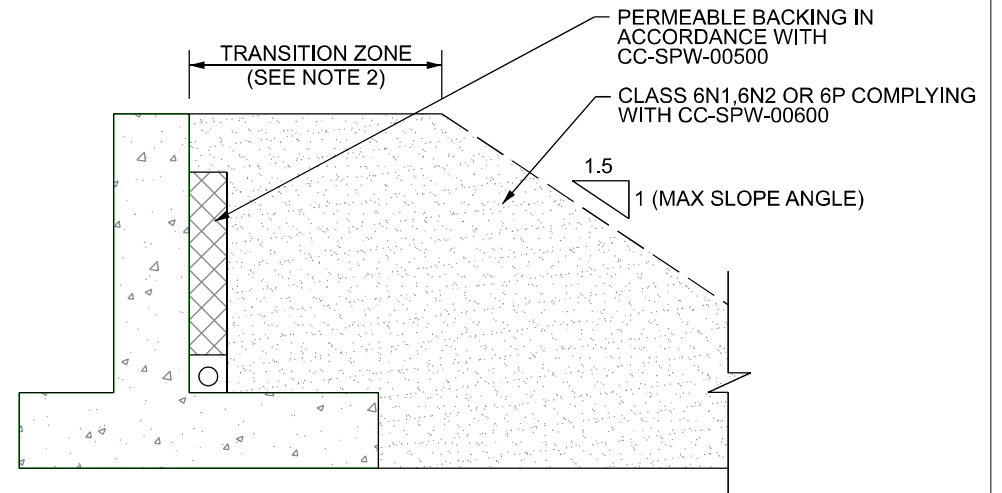

STRUCTURE CONSTRUCTED IN ADVANCE OF EARTHWORKS

- NOTES:-
1. THE WIDTH OF THE TRANSITION ZONE SHALL BE SHOWN ON THE RELEVANT STRUCTURES DRAWING.
  2. MINIMUM WIDTH OF THE TRANSITION ZONE SHALL BE DETERMINED BY
    - (A) THE REQUIREMENTS OF GOOD COMPACTION, SO AS TO REDUCE TO A MINIMUM DIFFERENTIAL SETTLEMENT BETWEEN THE EARTHWORKS AND THE STRUCTURE AND
    - (B) THE NEED TO SATISFY THE PRINCIPLES USED IN THE CALCULATION OF THE EARTH PRESSURE ON THE STRUCTURE.
 BUT SHALL NOT BE LESS THAN 1.0m.
  3. THE GEOMETRY OF THE STRUCTURE IS SHOWN FOR DIAGRAMMATIC PURPOSES ONLY.