

LONGITUDINAL SECTIONS

LETTER D TO BE CAST INTO MIX ST5 CONCRETE BLOCK TO A DEPTH OF 10. ALL LETTERS AND FIGURES TO COMPLY WITH THE TRANSPORT MEDIUM ALPHABET 62.5 'x' HEIGHT.

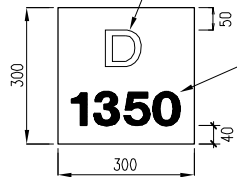

DEPTH OF DUCT TO INVERT IN MILLIMETRES CAST 5 MIN DEEP INTO BLOCKS.

MARK REQUIRED FOR DUCT WHERE COVER DEPTH IS 1500 OR LESS BELOW FINAL LEVEL

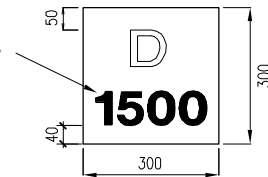

MARK REQUIRED FOR DUCT WHERE COVER DEPTH IS MORE THAN 1500 BELOW FINAL LEVEL

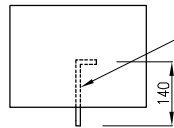
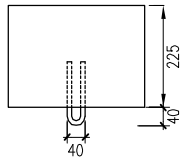

5 DIA GALVANISED STEEL EYE FOR FIXING DRAW ROPE. EYE MAY BE CAST INTO A RECESS IN BLOCK NOT EXCEEDING 40 DEEP x 100 x 100

DETAIL OF MARKER BLOCK

TO BE POSITIONED OVER DUCT IN VERGES AND ON CENTRE LINE IN CENTRAL RESERVE. SLACK IN DRAW ROPE (MINIMUM 1m) TO BE COILED UNDER BLOCK

CLOSE BOARDED FENCE POST TO COMPLY WITH BS 1722 PT.5 TYPE PCR. 105 OR SIMILAR WITHOUT RECESS, WITH THE ADDITION OF CAST LETTERING AS DETAILED BELOW.

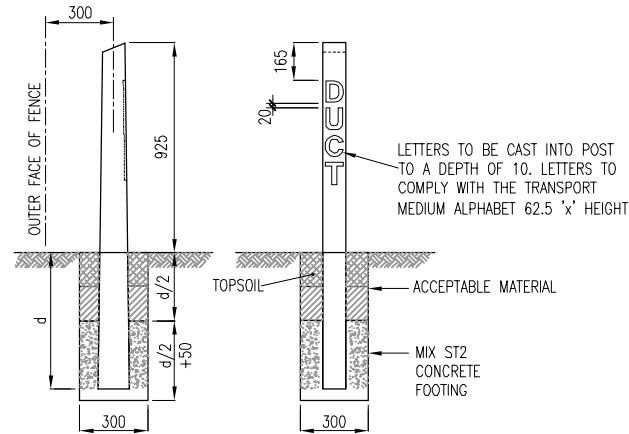

DUCT LOCATION POST

TO BE INSTALLED ON \varnothing OF DUCT GROUP

NOTES:

- ALL DIMENSIONS ARE IN MILLIMETRES EXCEPT WHERE STATED.
- DUCTS TO BE 100mm INTERNAL DIAMETER UNLESS OTHERWISE STATED IN APPENDIX 5/2.
- FOR DETAILS OF LOCATION OF DUCTS SEE THE LAYOUT PLANS.
- FOR DETAILS OF THE PERMITTED FORMS OF CONSTRUCTION FOR DUCTS SEE DRAWING No RCD/500/51.
- DUCTS ARE TO BE LAID STRAIGHT EXCEPT WHEN THEY HAVE TO CURVE AROUND OBSTACLES AND AT THE END OF DUCTS. NO CHANGE OF DIRECTION TO BE GREATER THAN 1 IN 30. THE MANDREL SHOWN ON DRAWING No RCD/500/52 SHALL BE DRAWN THROUGH THE COMPLETED DUCT.
- ALL DUCTS SHALL EXTEND A MINIMUM OF 600mm BEYOND THE PAVEMENT CONSTRUCTION AND WHERE POSSIBLE THE DRAINAGE TRENCH.
- DUCTS AND MARKERS SHALL NOT BE SITED UNDER SAFETY FENCE POSTS.
- WHERE DESCRIBED IN APPENDIX 5/2, 14/4 OR 15/1 MARKER BLOCK TERMINALS SHALL BE REPLACED WITH DUCT CHAMBERS.
- SEE DRAWING No RCD/500/52 FOR DUCT CROSSING TYPES.

NOT TO SCALE

	ROAD CONSTRUCTION DETAILS	DUCTS	P3	01/09	TRANSVERSE DUCTS	Drawing No.
			P2	10/07		
			P1	03/00		
			Issue	Date		RCD/500/50