

63mm MESH, 2.24/3.15mm $\phi$  PLASTIC COATED GALV. M.S WIRE CHAINLINK TO I.S. 130.

BARBED WIRE

CONCRETE STRAINING POST (125mm Sq. TAPERING TO 100mm Sq.)

M.S. STIFFENING ROD

STRAINING WIRE

RACHET

CONC. INTERMEDIATE POSTS (125mm Sq. TAPERING TO 100x87)

2650mm STRUT

TOPSOIL

MIX ST4 CONCRETE

ELEVATION

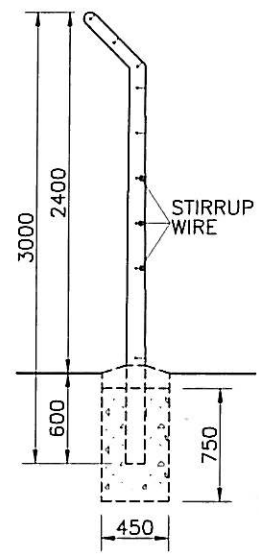

SECTION

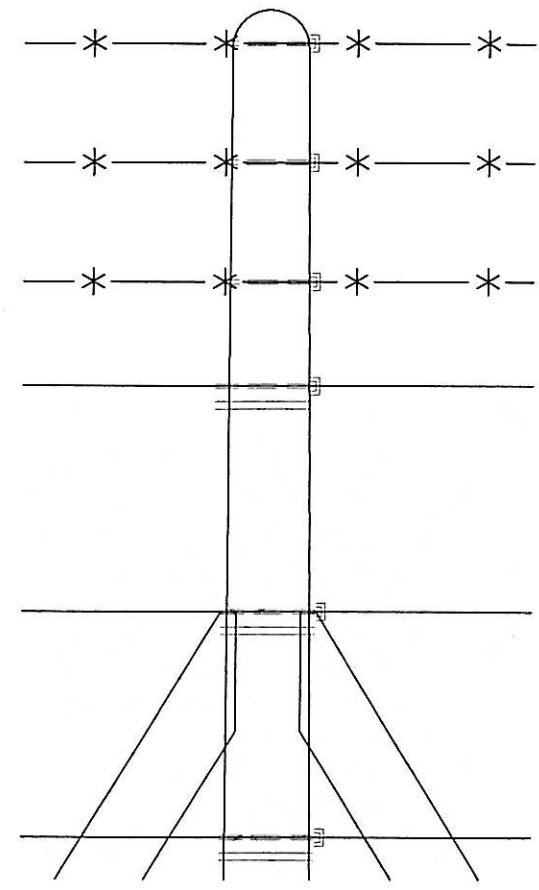

DETAIL

STRAINING POST AT APPROX. 50m c/c, CORNERS AND CHANGES IN DIRECTION, WITH 2No. 100x100 x2550 LONG STRUTS.

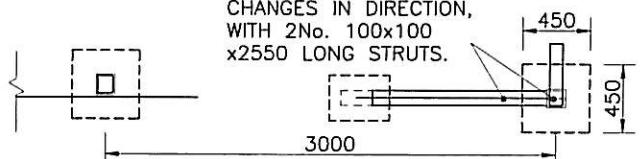

STRAINING WIRES FIXED TO INTERMEDIATE POSTS WITH STIRRUP WIRE

PLAN

NOTES :

1. ALL DIMENSIONS ARE IN MILLIMETRES.
2. ALL LINE WIRE, STIRRUP WIRE AND BARBED WIRE SHALL BE ZINC COATED TO COMPLY WITH B.S. 443.
3. WHEN THIS TYPE OF FENCE OR VARIATIONS OF IT ARE USED FOR ACCOMMODATION WORK FENCES, THE REQUIREMENTS ARE INCLUDED IN APPENDIX 1/15 AND ON THE DRAWINGS.