

TOP HINGE ELEVATION

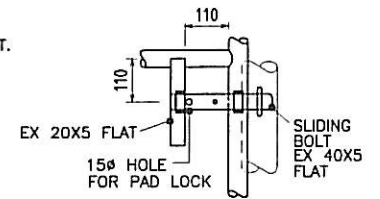

ELEVATION

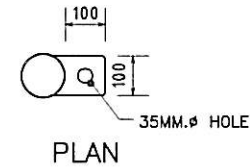

PLAN

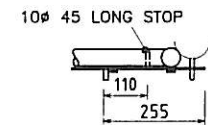

PLAN

MATERIAL DESCRIPTION	SIZE	FIXINGS
HANGING POST ( TUBULAR STEEL )	114.3mm EXT. DIA. 3.6mm THICK	CAP PLATES 4.8mm THICK. BASE PLATES 250X250X4.8mm THICK. CAP & BASE PLATES TO BE CONTINUOUSLY FLUSH WELDED TO TUBE.
SHAPING POST ( TUBULAR STEEL )	88.9mm EXT. DIA. 3.2mm THICK	WING PLATES 250X250X4.8mm THICK STITCH WELDED TO POST.
MAIN FRAME ( TUBULAR STEEL )	48.3mm EXT. DIA. 2.9mm THICK	---
INFILLING HORIZONTAL RAILS ( TUBULAR STEEL )	42.4mm EXT. DIA. 2.6mm THICK	---
BRACES (FLAT STEEL) 3 VERTICAL, 2 DIAGONAL	38X4.8mm	FILLET WELDED TO EACH GATE MEMBER CROSSED BY BRACES
MESH FABRIC ( IF SPECIFIED )	51mm SQ. X 4.1mm $\phi$ STEEL SQUARE WELDED MESH FABRIC.	---

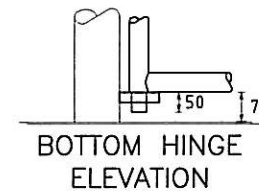

BOTTOM HINGE ELEVATION

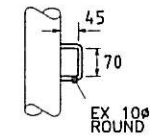

SHUTTING POST DETAIL

HINGE DETAILS

SLIDING BOLT LATCH DETAILS

NOTES:

- ALL DIMENSIONS ARE IN MILLIMETRES.
- GATES SHALL COMPLY WITH THE APPROPRIATE CLAUSES IN THE 300 SERIES AND ANY FURTHER REQUIREMENTS IN APPENDIX 1/15 OR 3/1.
- GATES SHALL OPEN INWARD FROM THE ADJACENT CARRIAGEWAY INTO THE OWNER'S PROPERTY.
- HINGES AND LATCH AS DETAILED.
- THE CORNERS OF THE MAIN FRAME MAY BE ROUNDED OR MITRED.
- GATES & FITTINGS SHALL BE GAVANISED TO COMPLY WITH BS 729 UNLESS ALTERNATIVE PROTECTIVE TREATMENT DESCRIBED IN APPENDIX 1/15 OR 3/1.
- GATE STOPS TO BE PROVIDED IN ACCORDANCE WITH RCD/300/14.